

GEM GRAVURE COMPANY, INC.



Wire Identification Systems and Inks

GEM
Accessories
FOR INKJET
&
TRADITIONAL
EQUIPMENT

REV. C 11619

GEM GRAVURE COMPANY, INC. World Leader in Wire Identification

Marking Machinery & Equipment - Gravure Printing Wheel - Inks, Dyes & Coatings - Non-contact Ink Jet Printing Systems

112 School Street, P.O. Box 1158, West Hanover, MA 02339 USA - Tel. (781) 878-0456 - Fax. (781) 871-2753 - E-mail: sales@gemgravure.com

41-1008
PRINTER STAND 1.5"

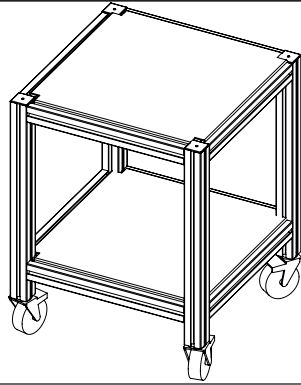

67200
HEAVY DUTY PRINTER
STAND

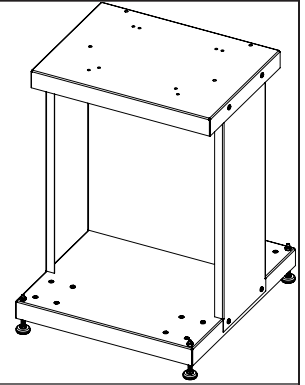

41-1065
PRINTER STAND W/BOOM
ARM (SHORT)
41-1073
PRINTER STAND W/BOOM
ARM (LONG)

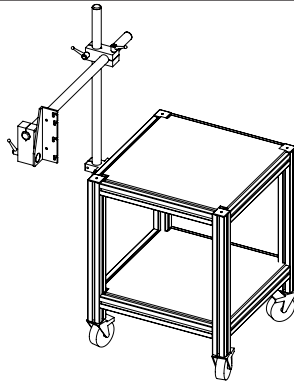

41-1071
DUAL PRINTER
STAND

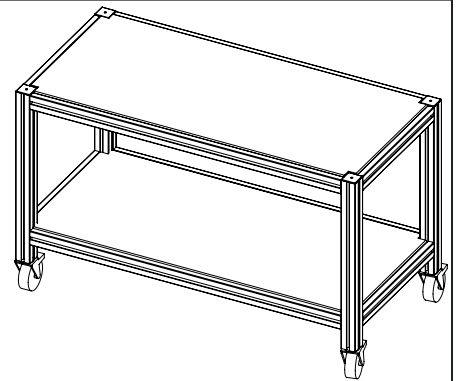

50-1092
CLEANING STATION WITH STAND
ATTACHMENT

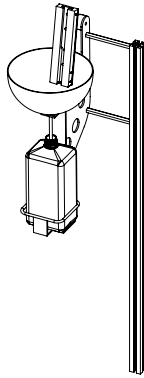

1038.5267
CLEANING STATION

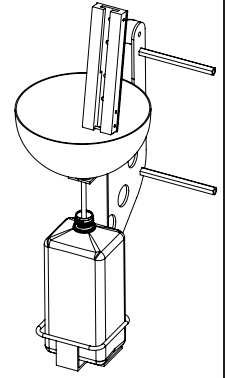

98-0072
HEAVY DUTY ADJUSTABLE
STAND

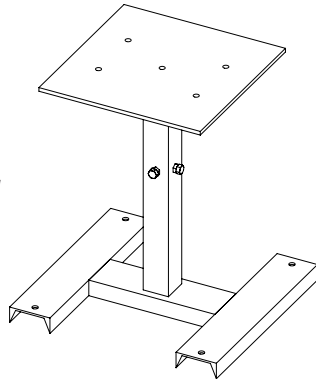

98-0222
HD WIRE MANUFACTURING
GUIDE W/STAND

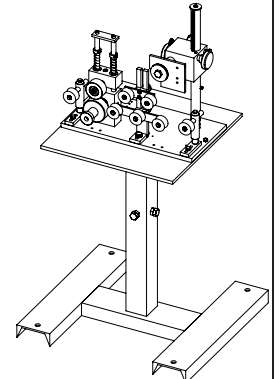

98-0059
WIRE MANUFACTURING
GUIDE

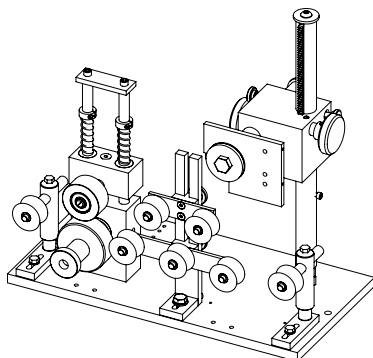

98-0247
WIRE MANUFACTURING
GUIDE
W/DUAL XY
HEADS ON
HD STAND

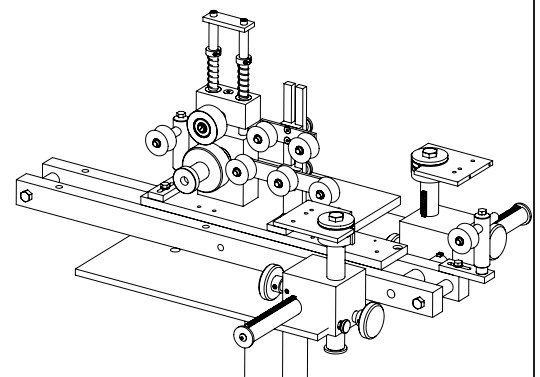

40-4335
SPRING PRESSURED INCOMING
GUIDE ROLL ASSEMBLY

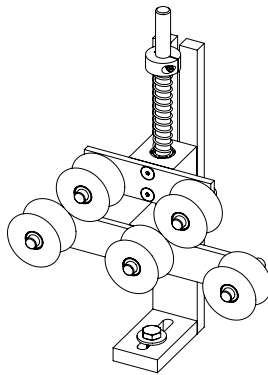

98-0076
INCOMING GUIDE ROLL
ASSEMBLY

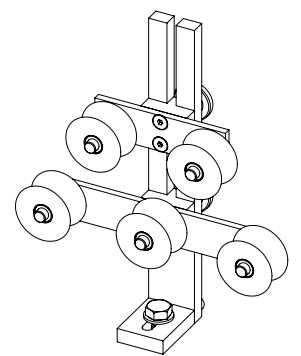

40-4328
ENCODER DRIVE ASSEMBLY

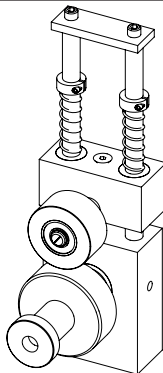

98-0274
XY HEAD ADJUSTMENT

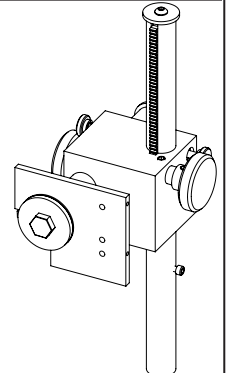

98-0318
PEDESTAL STAND 18" BASE

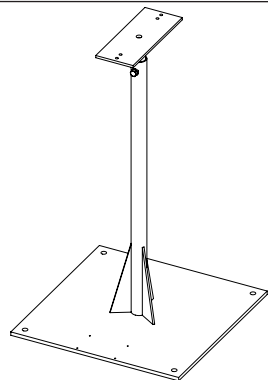

98-0221
PEDESTAL STAND 10" BASE

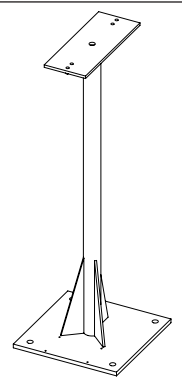

40-4323
XY HEAD ADJUSTMENT ON MINI
STAND W/EXTENSION

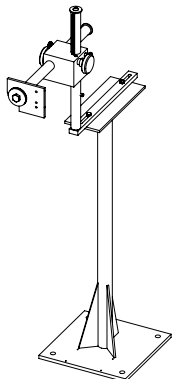

40-4321
XY HEAD ADJUSTMENT ON MINI
STAND

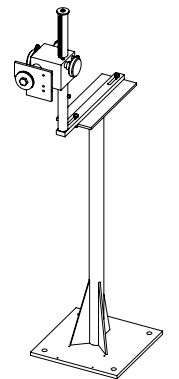

40-4325
XY HORIZONTAL FINE ADJUSTMENT
ON MINI STAND

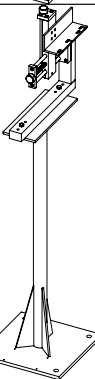

98-0320
XY HEAD ADJUSTMENT ON MINI
STAND W/18" BASE

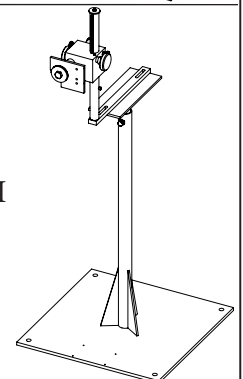

40-4327
ENCODER DRIVE ASSEMBLE ON MINI
STAND

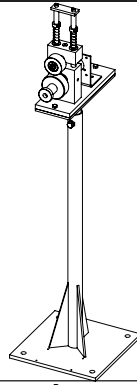

41-1059
SINGLE HEAD BOOM STAND

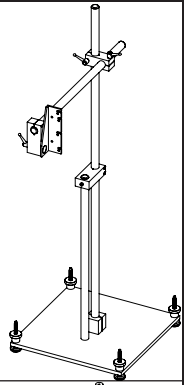

50-0062
TWO HEAD BOOM STAND FOR SIDE
PRINTING

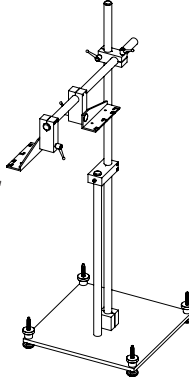

50-1003
TWO HEAD BOOM STAND FOR TOP
AND BOTTOM PRINTING

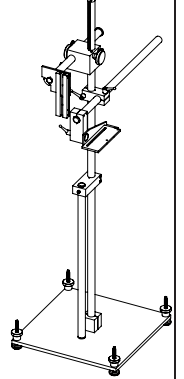

1008.2843
CABLE GUIDE UNIT
W/ENCODER 5000
PULSE
50-0095
CABLE GUIDE UNIT
W/ENCODER 2000
PULSE

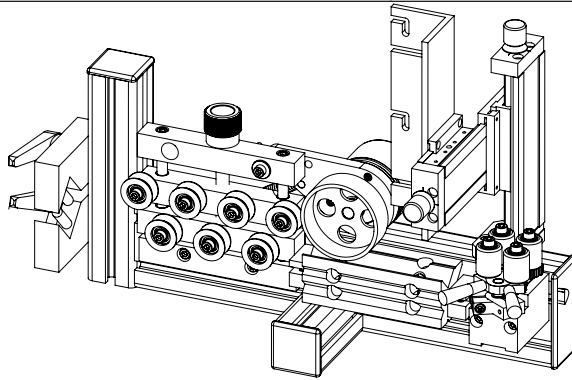

50-1110
UNIVERSAL
PRINT HEAD
MOUNT
(STANDARD)

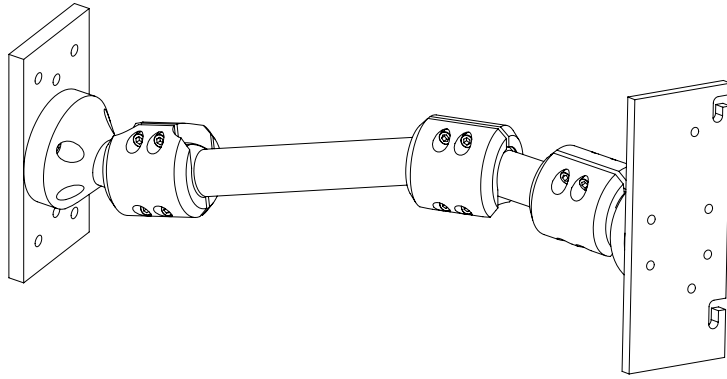

50-1111
UNIVERSAL
PRINT HEAD
MOUNT
(SMALL)

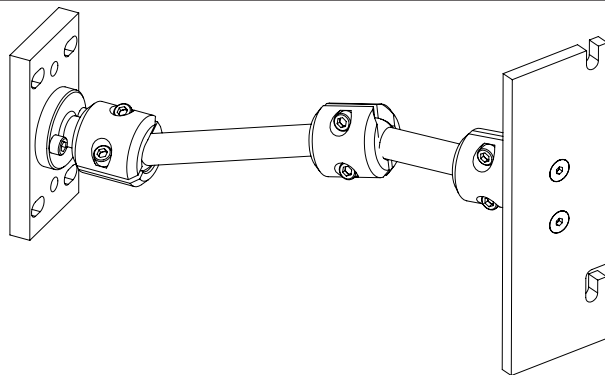

50-1009
SENSOR BRACKET
LEFT

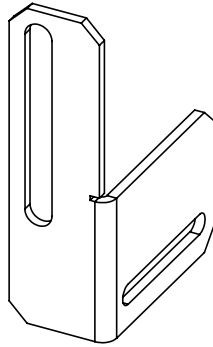

50-1010
SENSOR BRACKET
RIGHT

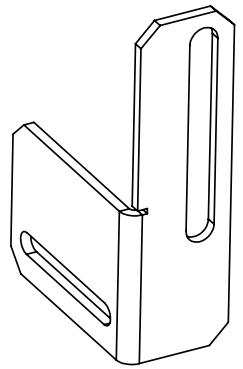

50-0083
FIBER SENSOR
BRACK
STRAIGHT

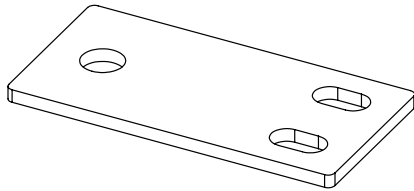

50-0084
FIBER SENSOR BRACKET
90°

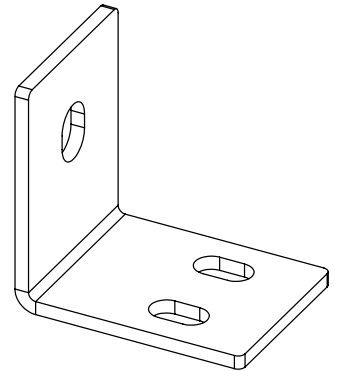

50-0093
LASER PRODUCT SENSOR

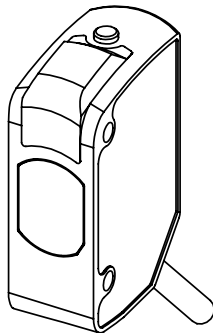

50-1065
LASER SENSOR BRACKET

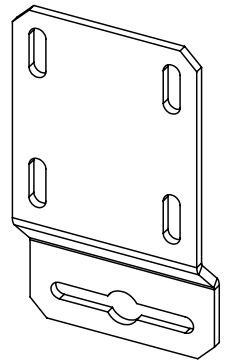

50-0075
FIBER REFLECTIVE
CABLE

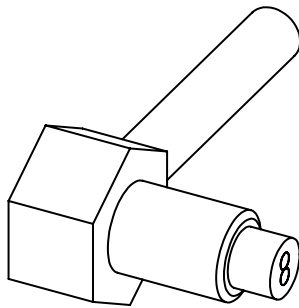

50-0076
ARMORED FIBER RE-
FLECTIVE STRAIGHT
CABLE

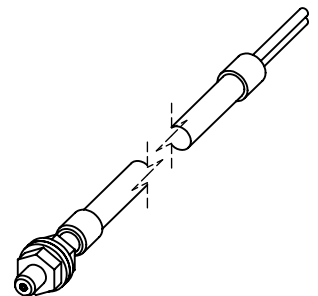

50-0077
FIBER PHOTO EYE AMPLIFI-
ER

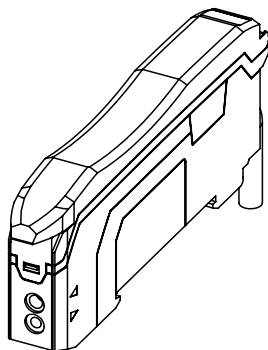

50-0078
AROMARED
FIBER THRU
BEAM CABLE

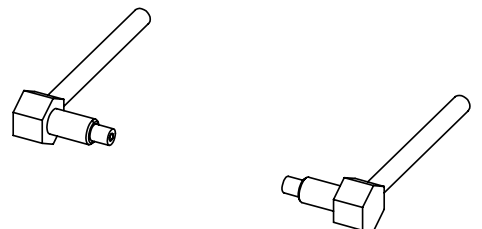

50-0079
ARMORED FI-
BER THRU BEAM
STRAIGHT CABLE

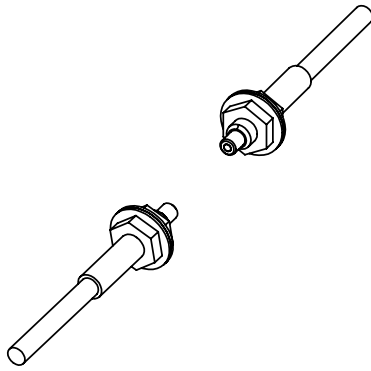

50-0003
1/4" SFT.
2000 PULSE

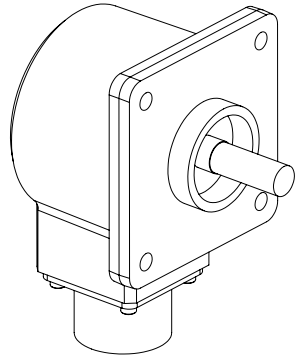

50-0032
3/8" SFT.
2000 PULSE

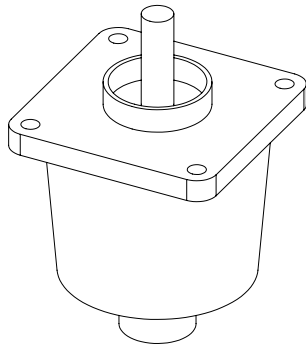

50-0071
3/8" SFT.
5000 PULSE

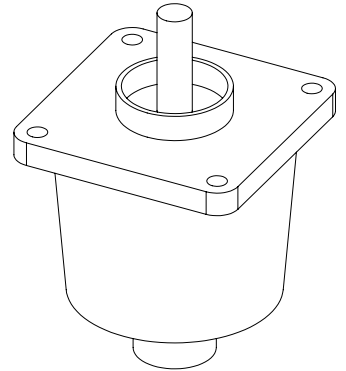

50-1074
3/8" SFT.
5000 PULSE

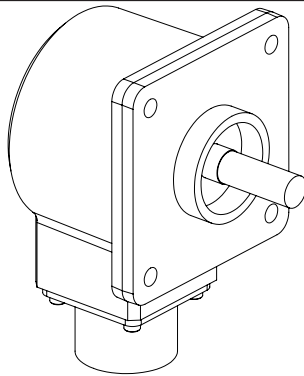

39-0007
MOUNTING BRACKET
FOR ENCODER

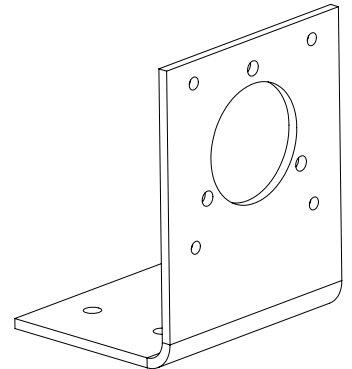

50-0015
25" ENCODER CABLE
AJC, EVO

50-0015-50
50-0015-75
50-0015-100
FT

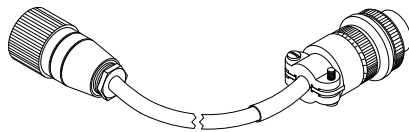

50-0014
ENCODER 5000PPR
W/BACKET AND
CABLE

50-0014-50
50-0014-75
FT

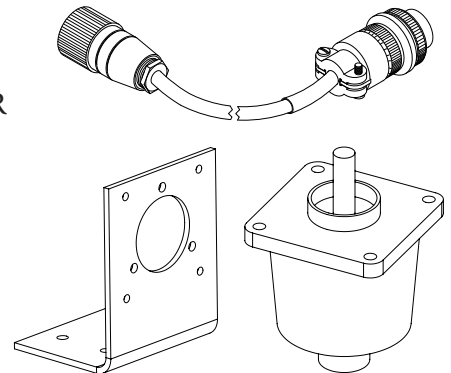

50-0023
EVO/INTO RESET
SWITCH

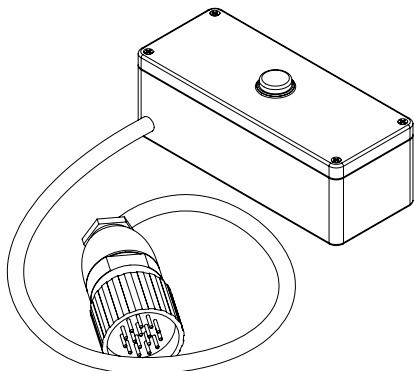

1007.2588
7 PIN CONNECTOR

1007.2593
16 PIN CONNECTOR

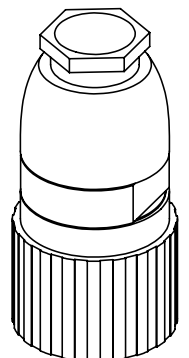

50-1141
2048PPR. ENCODER W/INTEGRAL
ARM & CABLE

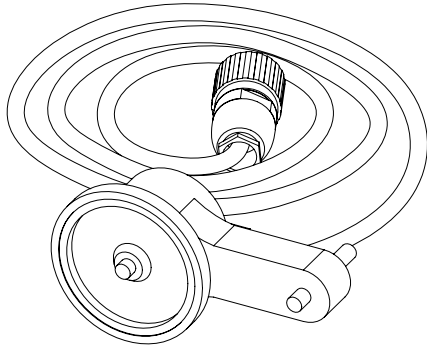

50-1151
ENCODER BRACKET
FOR 50-1141

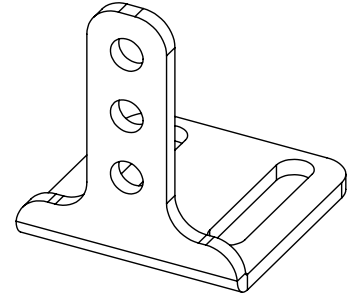

1037.8204
QUICK MOUNT FEMALE SIDE FOR EPTI
PRINT HEAD BRACKET

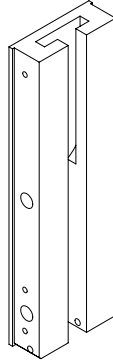

1037.8208
PRINT HEAD BRACKET FOR EPTI

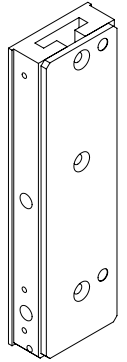

1007.2185
200MM CIR. ENCODER
WHEEL FOR 3/8"
SFT.

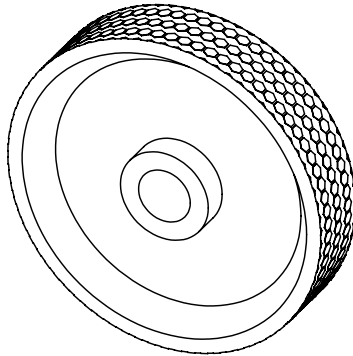

50-0057
12" CIR. ENCODER
WHEEL FOR 3/8" SFT.

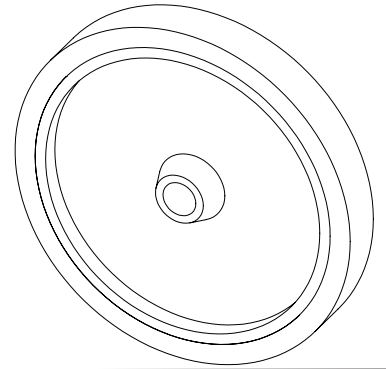

40-4318
3/8" FLEXIBLE COUPLING
FOR ENCODERS

